



CCT & lumen selectable
Economy
LED Flood



*available on selected models

PROJECT: _____

DATE: _____

TYPE: _____

PREPARED BY: _____



KEY FEATURES

100,000-Hour LED lifespan

0-10V dimming standard on all models

Selected models include **photocell control**

Selected models **3000/4000/5000K & lumen field-selectable**

Multi-mounting options provided

TECHNICAL SPECIFICATIONS

COMPLIANCE

UL Listed

Suitable for wet locations

IESNA LM79 & LM-80 Testing

PacLights LED luminaires have been tested by an independent laboratory in accordance with IESNA LM-79 and LM-80.

DLC Qualification

Selected models of this product are on the Design Lights Consortium (DLC) Qualified Products List and are eligible for rebates from DLC Member Utilities. To view our DLC qualified products, please consult the DLC Qualified Products List at www.design-lights.org/qpl

LED CHARACTERISTICS

LEDs

Long-life, high-efficacy, surface-mount LEDs

Lifespan

100,000-hour LED lifespan based on IES LM-80 results and TM-21 calculations

Color Rendering Index

>70 (15w/30w/50w models); >80 (70w/90w models)

Beam Angle

100°, 7H6V distribution

Field-selectable Color Temperature

On selected models (3CCT), 3000K/4000K/5000K, selectable by dip switch

Color Uniformity

PacLights' range of Correlated Color Temperature follows the guidelines of the American National Standard for Specifications for the Chromaticity of Solid State Lighting (SSL) Products, ANSI C78.377-2017

OTHER

5-Year Limited Warranty**

The PacLights 5-year, limited warranty covers light output, driver performance and paint finish.

**PacLights's warranty is subject to all terms and conditions found at paclights.com/warranty

CONSTRUCTION

IP Rating

IP 65 Rated

Ambient Temperature

Suitable for up to 50° C (122° F) ambient temperature

Cold Weather Starting

The minimum starting temperature is -40 F°/-40° C

Housing

Die-cast aluminum housing

Gaskets

Silicon Gaskets

Finish

Our environmentally friendly polyester powder coatings are formulated for high-durability and long-lasting color, and contain no VOC or toxic heavy metals.

Mounting Methods

knuckle mount (included for 15w/30w/50w models, optional for other models)
flood mount (included for 70w/90w models, optional for other models)
yoke/trunnion mount (optional, available for all models)
arm mount, splitter mount (optional, available for 70w/90w models only)

Green Technology

Mercury and UV free, and RoHS compliant. Polyester powder coat finish formulated without the use of VOC or toxic heavy metals.

Lens

Polycarbonate

ELECTRICAL

Drivers

0-10V Dimmable
Input Voltage: 120-277V, 50-60 Hz
Power Factor > 0.9; THD <15%

Photocell Control

Pre-installed sensor (on -3CCT- models only), dusk-to-dawn on-and-off operation. 15±10 lux ON, 50±20 lux OFF.

TECHNICAL SPECIFICATIONS Continued

FFLA/2 - 15/30

weight 2.5 lbs

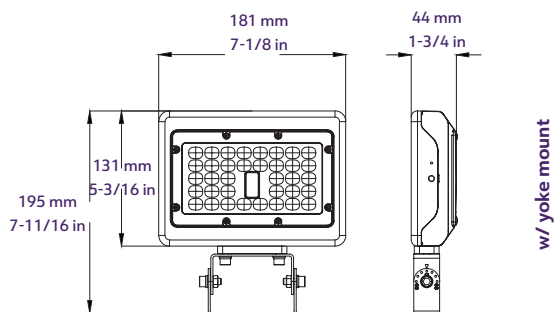
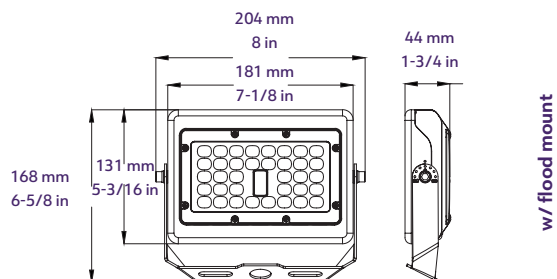
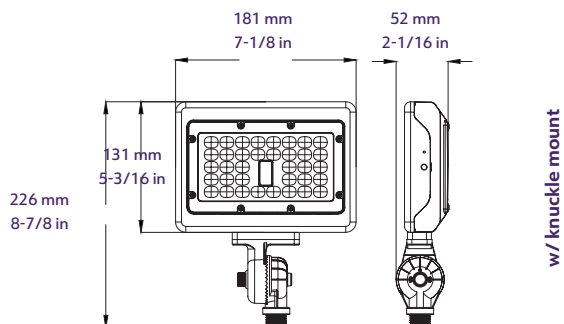

FFLA/2 - 50

weight 3.7 lbs

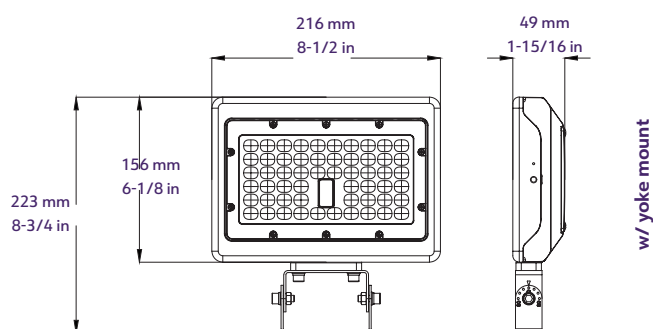
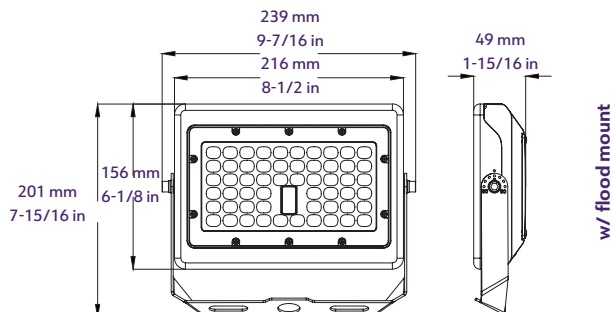
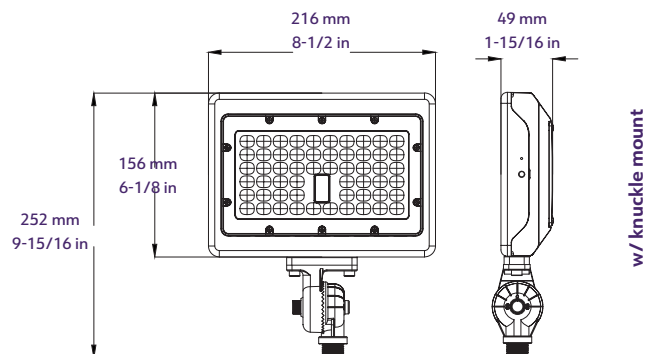

FFLA/2 - 70/90

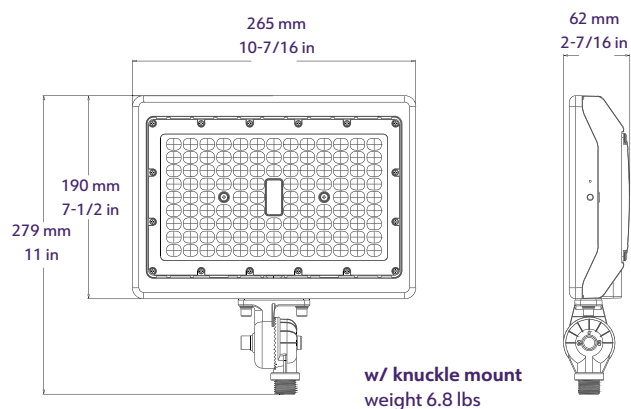
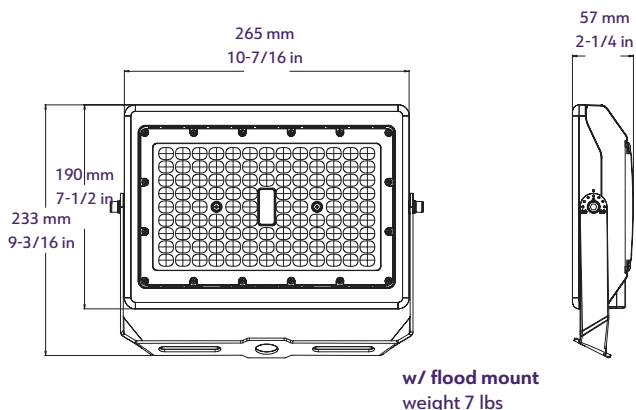

TECHNICAL SPECIFICATIONS Continued

FFLA/2 - 70/90 (continued)

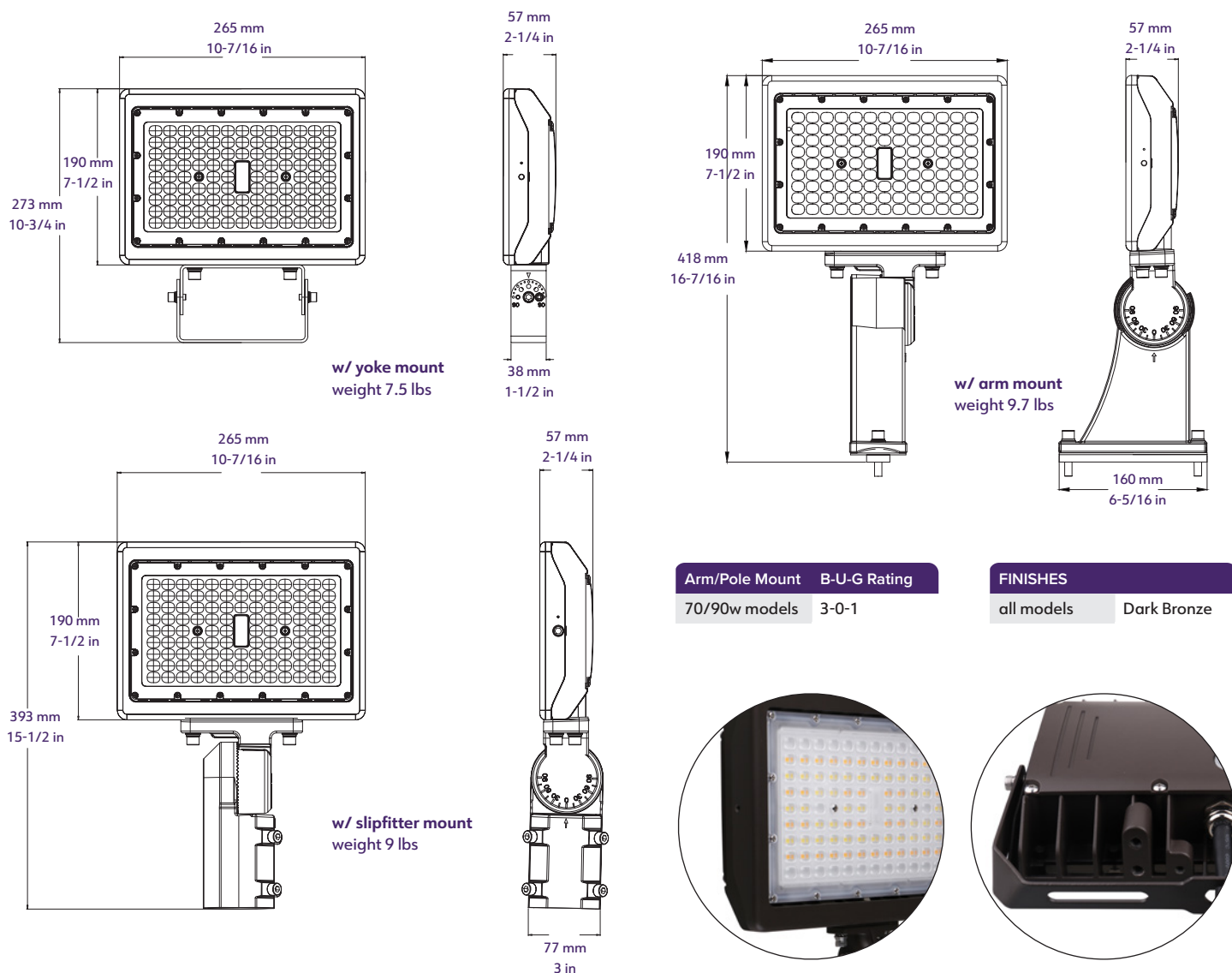

CCT & LUMEN SELECTABLE with PHOTO CONTROL (3-IN-1) on selected models

CCT SELECTABLE

Selected models (-3CCT-) are equipped with color temperature settings ranging from: 3000K (Warm White), 4000K (Neutral White) and 5000K (Daylight). Simply use the switch directly on the fixture to select the desired color temperature and then install. Selectable color temperature technology removes the guesswork of choosing the correct color temperature for your space. Select 3000K in applications requiring warm and inviting light, select 4000K for a slightly cooler light appearance, select 5000K in areas requiring bright, crisp light. Simply select by adjusting the dip switch.

LUMEN SELECTABLE

Selected models (-3CCT-) are equipped with the dip switch for lumen to be adjusted to 100%, 90%, 80% or 70% of the total output.

PHOTOCONTROL

Photocell Control allows ON/OFF switching the luminaires, to be determined by the amount of daylight present. Specified low light levels at dusk will turn lights ON. When sufficient daylight returns at dawn, the lights automatically turn OFF. Automatic lighting controls save energy. It can be disabled by adjusting the dip switch.



MOUNTING options

FLOOD

for surface/wall mount, rotatable.



KNUCKLE

for junction box with 1/2" opening, rotatable.



YOKE

for surface mount, can be rotated up to 270°



SLIPFITTER

for 2-3/8" round light pole tennon, rotatable



ARM

for round or square light poles, rotatable



PERFORMANCE

FFLA/2 - 15

15W	3000K Warm white	4000K Neutral	5000K Daylight
LUMENS	2,099	2,190	2,282
LM/W	134	139	145

FFLA/2 - 30

30W	3000K Warm white	4000K Neutral	5000K Daylight
LUMENS	3,873	4,043	4,214
LM/W	134	140	146

FFLA/2 - 50

50W	3000K Warm white	4000K Neutral	5000K Daylight
LUMENS	6,626	6,918	7,210
LM/W	131	136	142

FFLA/2 - 70

70W	3000K Warm white	4000K Neutral	5000K Daylight
LUMENS	9,526	9,895	10,260
LM/W	129	134	139

FFLA/2 - 90

90W	3000K Warm white	4000K Neutral	5000K Daylight
LUMENS	11,320	11,680	12,135
LM/W	125	129	134



ORDERING INFORMATION

FFLA™ generation 2

Family	Model	Color Temp	Mounts
FFLA/2	—	—	—
15	15w	30	3000K (warm white)
30	30w	40	4000K (neutral)
50	50w	50	5000K (daylight)
70	70w	3CCT	3000/4000/5000K & lumen selectable, photocontrol included
90	90w		
			KM ¹ knuckle mount FM ² flood mount YM yoke mount SF ³ slipfitter mount AM ³ arm mount

Note: 1) included on 15w/30w/50w models, 2) included on 70w/90w models, 3) only available on 70w/90w models