

PacLights

Commercial & Industrial Lighting



The  
**FFHE**<sup>TM</sup>  
Series

Sports and Flood Lights





## Sports and Flood Light



PROJECT: \_\_\_\_\_

DATE: \_\_\_\_\_

TYPE: \_\_\_\_\_

PREPARED BY: \_\_\_\_\_



### KEY FEATURES

**1000w Metal Halide equivalent****Mounting Options** for sports and flood applications**10kV Surge Protection** standard on all modelsCompatible with **NEMA 3/5/7 prong Twist-lock** lighting controls**Networked Lighting Control** option

## TECHNICAL SPECIFICATIONS

### COMPLIANCE

#### UL Listed

UL 1598, Suitable for Wet Locations

#### IESNA LM79 & LM-80 Testing

PacLights LED luminaires have been tested by an independent laboratory in accordance with IESNA LM-79 and LM-80.

#### DLC Qualification

Selected models of this product are on the Design Lights Consortium (DLC) Qualified Products List and are eligible for rebates from DLC Member Utilities. To view our DLC qualified products, please consult the DLC Qualified Products List at [www.design-lights.org/qpl](http://www.design-lights.org/qpl)

### OPTICAL

#### LEDs

Long-life, high-efficacy, surface-mount LEDs

#### Lifespan

100,000-hour LED lifespan based on IES LM-80 results and TM-21 calculations

#### Lumen Maintenance

L90 ≥ 36,000 hours

#### Color Rendering Index

&gt;70

#### Beam

30° beam, NEMA 4, B5-U0-G3.

#### Color Uniformity

PacLights' range of Correlated Color Temperature follows the guidelines of the American National Standard for Specifications for the Chromaticity of Solid State Lighting (SSL) Products, ANSI C78.377-2017

### OTHER

#### 5-Year Limited Warranty\*\*

The PacLights 5-year, limited warranty covers light output, driver performance and paint finish.

\*\*PacLights's warranty is subject to all terms and conditions found at [paclights.com/warranty](http://paclights.com/warranty)

### CONSTRUCTION

#### IP Rating

Ingress Protection rating of IP65 for dust and water

#### Ambient Temperature

Suitable for up to 50° C (122° F) ambient, minimum starting -40 F°/-40° C

#### Housing

Die-cast aluminum housing; stainless steel external hardware; silicone gasket.

#### EPA

1.4 ft².

#### Mounting Methods

Yoke/Trunnion (standard); 2-3/8" Slipfitter (optional), Knuckle (optional).

#### Green Technology

Mercury and UV free, and RoHS compliant.

#### Lens

Polycarbonate.

### ELECTRICAL

#### Driver(s)

Designed to last ≥50,000 hours when at allowable operating temperature  
Input Voltage: 120-277v AC (-UV models) or 220-480v AC (-HV models), 50-60 Hz  
0-10V dimming; Power Factor > 0.95; THD < 20%

#### Surge Protector

Driver - L/N-PE: 10kV, L-N: 6kV; Secondary - 10kV.

#### Control Receptacle

NEMA 7-prong twist-lock receptacle. Compatible with ANSI C136.1 3-prong twist-lock photocell, or C136.41 0-10v 5 or 7-prong twist-lock dimming controls.

#### Input Current

Models	Wattage	120v	208v	240v	277v	480v
FFHE-600	600w	5.5A	3.2A	2.8A	2.4A	1.4A
FFHE-500	500w	4.6A	2.6A	2.3A	2.0A	1.1A
FFHE-400	400w	3.7A	2.1A	1.8A	1.6A	0.9A

## ORDERING INFORMATION

## FFHE™

FAMILY	MODEL	INPUT VOLTAGE	CCT	BEAM	MOUNTS	OTHER
FFHE	MODEL	VOLTAGE	CCT	BEAM	MOUNTS	OTHER

## EXAMPLE

FFHE-600-UV-50-D3-TM

FFHE-600-UV-50-D3-KM-VS

FFHE-600-HV-40-D3-SF-PS-VS

## MODEL

\* MUST SELECT ONE

CODE	LUMEN PACKAGE	WATTAGE
600	84,000	600w
500	70,000	500w
400	56,000	400w

## INPUT VOLTAGE

\* MUST SELECT ONE

CODE	INPUT VOLTAGE
UV	120-277v
HV	220-480v

## CCT

\* MUST SELECT ONE

CODE	CRI	CCT
50	> 70	5000K
40		4000K

## BEAM

\* MUST SELECT ONE

CODE	BEAM
D3	30°, NEMA 4

## MOUNTS (see page 5 &amp; 7)

\* MUST SELECT ONE

CODE	PARTS SKU	TYPE	INSTALL
TM	- INCLUDED -	Trunnion/Yoke Bracket	FACTORY
KM	AC-FHE-KM	Knuckle Bracket	FIELD
SF	AC-FHE-SF	Slipfitter Bracket for standard 2-3/8" tenon	

## OTHER

\* LEAVE BLANK, or SELECT ONE or MORE (connect with "-")

## Control (see page 6)

CODE	PARTS SKU	TYPE	FEATURES	INPUT VOLTAGE	COMPATIBLE	INSTALL
PS	SE-TLP277	Twist Lock Standalone Control	ON/OFF Photocell Sensor	120-277v	UV models	FIELD
	SE-TLP480			220-480v	HV models	
DL	SE-TLP277DLH		Daylight Dimming Photocell Sensor	120-277v	UV models	
	SE-TLP480DLH			220-480v	HV models	
DM	SE-TLP277DLM		Daylight and Mid-night Dimming Photocell Sensor	120-277v	UV models	
	SE-TLP480DLM			220-480v	HV models	
SYW	SE-SY-TL7-HVG	Twist Lock Wireless Networked Control	Synapse® wireless <sup>1</sup> intelligent On/Off switching, dimming, built in Photocell, Power Monitoring and GPS. Optional: Dynamic Behaviors <sup>2</sup> for Sports Lighting	110-480v	All models	

<sup>1</sup> Central Base Station (CBS) wireless site controller required, purchase separately, see Synapse® documents<sup>2</sup> Dynamic Behaviors licenses required, purchase separately, not all features available, contact sales

## Glare Shield (see page 6)

CODE	PARTS SKU	TYPE	INSTALL
VS	AC-FHE-VS	Visor / Glare Shield	FIELD

PERFORMANCE

	Models	Lumen Package	Wattage	CCT	Lumen Output	LPW
Delivered Lumens, 70 CRI	FFHE-600	84,000	600w	4000K	84,600	141
				5000K	85,800	143
	FFHE-500	70,000	500w	4000K	70,500	141
				5000K	71,500	143
	FFHE-400	56,000	400w	4000K	56,400	141
				5000K	57,200	143

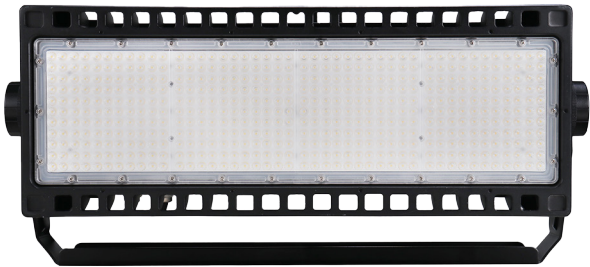

DLC CHART

Selected models of this product are on the Design Lights Consortium (DLC) Qualified Products List and are eligible for rebates from DLC Member Utilities. To view our DLC qualified products, please consult the DLC Qualified Products List at [www.designlights.org/qpl](http://www.designlights.org/qpl)

DLC Primary use designation: Architectural Flood and Spot Luminaires



MODEL#	CLASS	DLC PRODUCT ID
FFHE-500-HV-40-Dx-cdefP	Premium	S-KTP5DS
FFHE-500-HV-50-Dx-cdefP	Premium	S-R3KDQN
FFHE-500-UV-40-Dx-cdefP	Premium	S-NQ401X
FFHE-500-UV-50-Dx-cdefP	Premium	S-YX3GKH
FFHE-600-HV-40-Dx-cdefP	Premium	S-0H88DN
FFHE-600-HV-50-Dx-cdefP	Premium	S-CXHY5V
FFHE-600-UV-40-Dx-cdefP	Premium	S-RHXPVP
FFHE-600-UV-50-Dx-cdefP	Premium	S-46TQ53



STANDARD FEATURES

Secondary Surge Protector



Secondary 10kV surge protector can act as the second line of defense, in addition to the LED driver's integrated lightning arrester.

NEMA Twist-lock Controls Compatible



Pre-installed with NEMA 7-prong twist-lock receptacle. Compatible with ANSI C136.1 3-prong twist-lock photocell, or C136.41 0-10v 5 or 7-prong twist-lock dimming controls.

## MOUNTING Options

Yoke/Trunnion (standard: -TM)

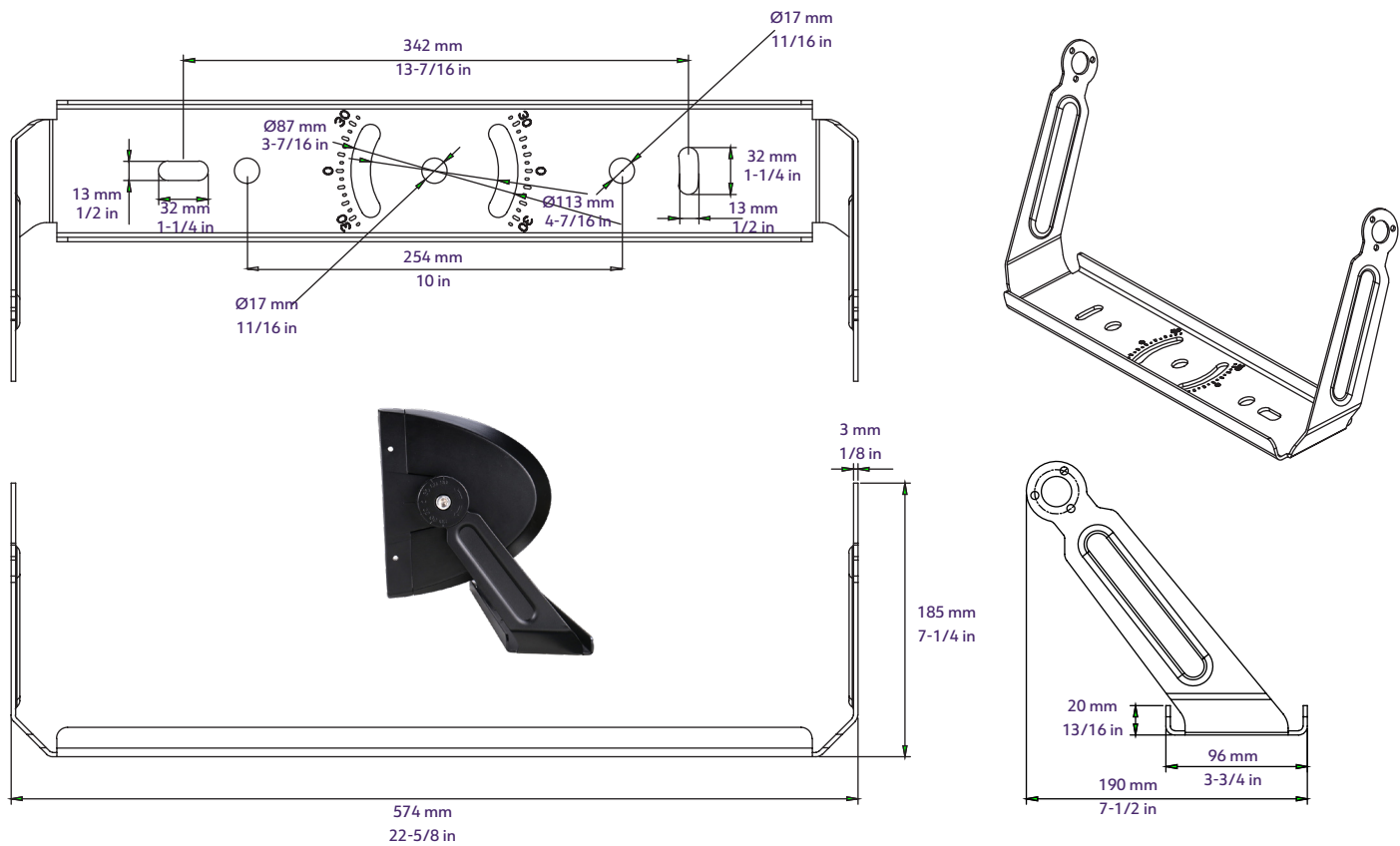

Knuckle (option: -KM)

Slipfitter (option: -SF)

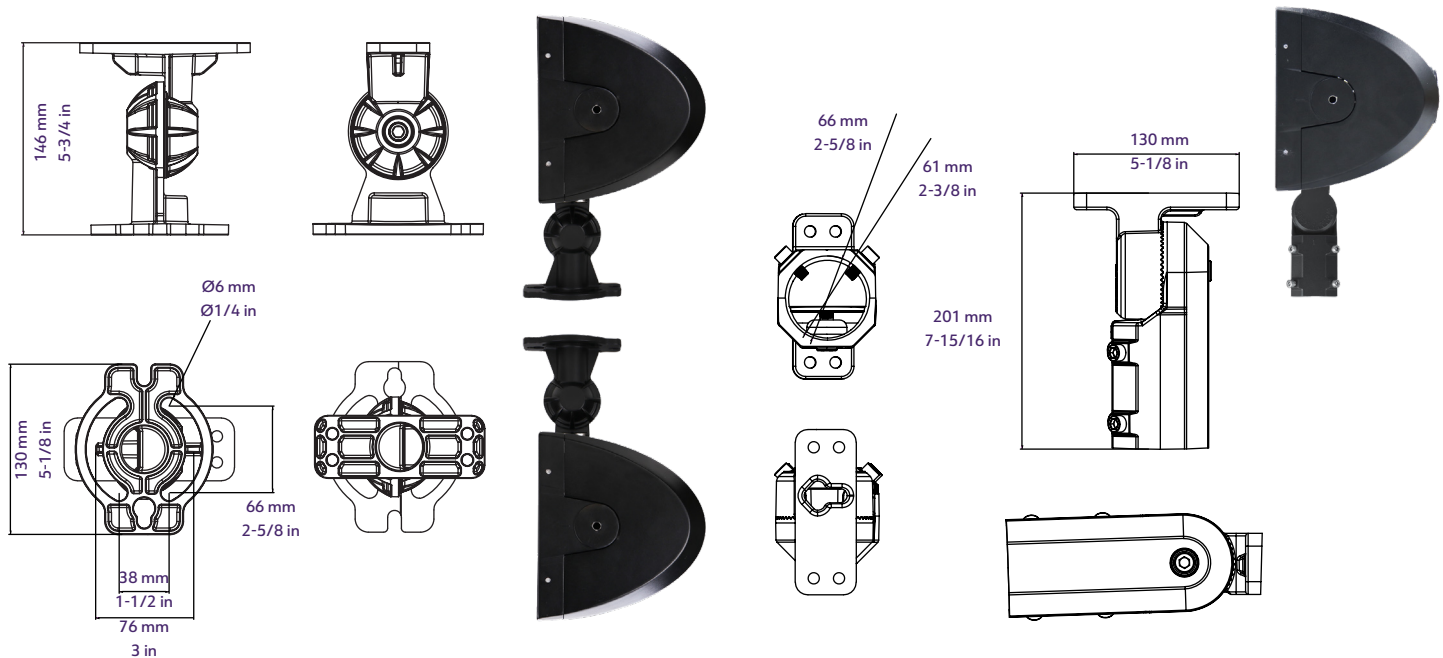



## CONTROL Options

## Standalone NEMA Twist-lock Photocell Sensors (option: -PS/-DL/-DM)

PacLights advanced electronic **SE-TLP Series** Photocontrol provides a unique, durable, and multi-volt control especially designed for 15 years of operation. It utilises inter-locking base/cap design for excellent environmental housing. High temperature base material, along with a UV stabilised, opaque housing ensure our control will last years without degradation. PacLights uses a process of IR filtering a phototransistor which in turn gives a human eye response along with long-term, drift free light sensing for the life of the control.



- Multi-volt options (120-277v, 480v)
- Daylight On/Off function (option: -PS)
- Daylight harvesting function (option: -DL)
- Mid-Night dimming function (option: -DM)
- High-temperature components
- MOV surge protection
- Meets or exceeds ANSI C136.10

for detail refer to **SE-TLP Series** specification

## Networked Lighting Control (option: -SYW)



Synapse SimplySnap Network Lighting Controls (NLC) offer Luminaire Level Lighting Control (LLLC) based on IEEE 802.15.4 Mesh Networking of Luminaires. Individual addressability enables luminaires to be communicated with each other within the network. Luminaires can be grouped and controlled by using a web app via the connected Central Base Station (CBS). Scheduling, scene and sensors can be added for automation among the lights within the zone/group.

The **TL7-HVG** is an intelligent SimplySnap wireless lighting controller designed for high voltage applications. Each TL7-HVG provides intelligent On/Off switching, dimming, external sensor input, highly accurate power metering, GPS, Tilt (optional) and status monitoring of lighting fixtures.

The **Central Base Station (CBS)** site controller serves as the heart of the SimplySnap solution. This network edge appliance provides quick browser-based access and local control of smaller systems with hundreds of devices. Each SimplySnap system includes a variety of Synapse-enabled devices that communicate with each other and the CBS to form a local mesh network. The CBS monitors, controls, and automates critical devices to save energy across different types of systems. For managing larger sites or multiple locations, optional SimplySnap cloud applications are available to consolidate multiple site controllers into a single user interface for integrated management across installations with thousands of devices.

**DYNAMIC BEHAVIORS** is optional separately purchased/licensed feature enables SimplySnap users to produce stunning lighting effects such as Paparazzi, Sparkle, Random etc.



TL7-HVG



Central Base Station (CBS)

## GLARE SHIELD Option

## Visor

For residential, tourist and conservation areas, facilities must be able to install lighting systems that avoid unwanted illumination onto adjacent properties.

PacLights engineered optical systems include visor that control light and distribute it on the task at hand to limit light trespass. This allows facilities to install luminaires and poles where they are needed for maximum effectiveness.

The visor of the FFHE can be installed on either side of the fixture, depending on specific requirements.

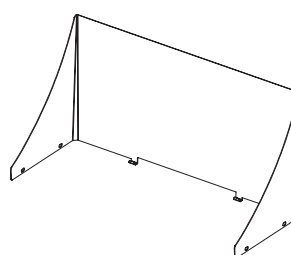
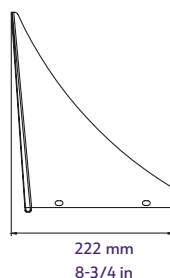
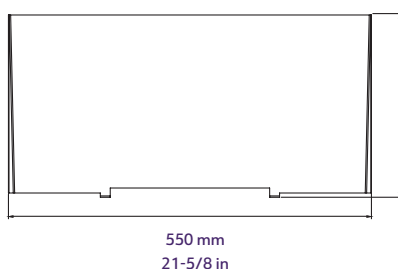

## DIMENSIONS

Weight: 35 lbs  
EPA: 1.4

## FINISHES

all models

black

Yoke/Trunnion (standard: -TM)

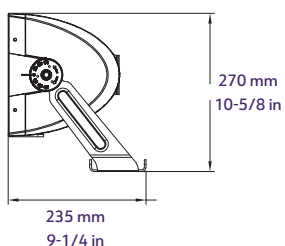
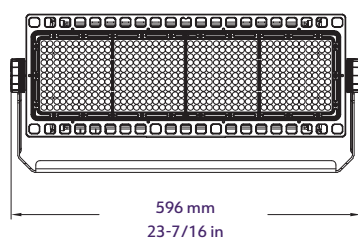

Knuckle (option: -KM)

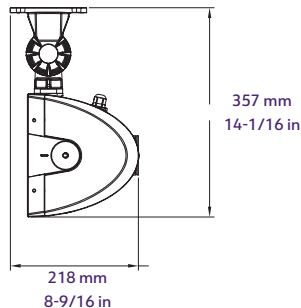
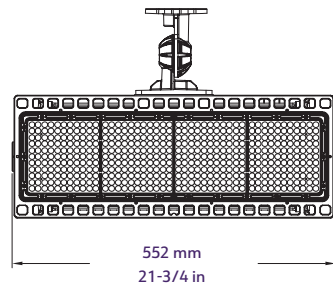

Slipfitter (option: -SF)

