

Commercial Lighting



The
FDLATM
Series

Field-adjustable LED Downlight





The **FDLA**[™] series

- High Performance LEDs for commercial applications
- Replacement for traditional Compact Fluorescent recessed downlights
- Lumen and CCT Selectable
- Compatible with new construction or retrofit installations
- Available in 3 CCTs: 3000K, 3500K, 4000K
- 0-10V dimmable
- Emergency backup and goof rings available
- IC rated, meets air-tight requirements, spring loaded retention clips
- ETL wet and Energy Star rated
- 5-Year warranty

Selectable CCT & Lumen



OUTPUT & CCT
FIELD
ADJUSTABLE

Tool-less integrated switch

Select the desired output power or light color temperature by sliding the respective Output Power or CCT Selection Switch up or down to the desired value. CCT can be adjusted to 3000/3500/4000K, and Output Power can be adjusted to:

- 6w / 8w / 12w for 4" models (FDLA04D12)
- 8w / 12w / 16w for 6" models (FDLA06D16)
- 12w / 16w / 22w for 8" models (FDLA08D22)
- 22w / 28w / 33w for 10" models (FDLA10D33)

Retrofit or New Construction

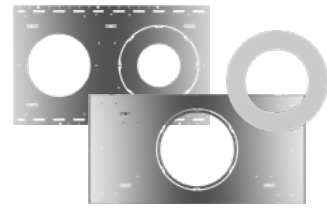

Perfect for both indoor and outdoor new construction or retrofit use.

- Optional new construction plate for stud/joist mounting, for 4", 6" and 8" models. (SKU: AC-DLA-DP)
- Optional new construction / remodel plate for T-Grid ceilings, for all models (SKU: AC-DLA-TP)
- Optional painted goof ring extender kit, 6" goof ring for 4" downlight (SKU: AC-DLA-GR4), 8" goof ring for 6" downlight (SKU: AC-DLA-GR6), 10" goof ring for 8" downlight (SKU: AC-DLA-GR8), 12" goof ring for 10" downlight (SKU: AC-DLA-GR10).

Emergency Backup

FDLA downlight can be installed with an optional emergency backup kit (SKU: EMH-25). When there is a power outage, the emergency backup driver and battery will power the FDLA for at least 90 mins.

Optional T-Grid bracket for Emergency kit (SKU: EMA-TGH) available.

Emergency backup kit works with 4", 6" and 8" FDLA models.



EMERGENCY
BACKUP
OPTION

ETL Listed



All models are IC rated for direct contact with insulation and suitable for use in dry, damp and wet locations.

Complies with the following standards:

- Standard for Luminaires, UL 1598

Complies with the following standards:

- CSA C22.2 No. 250.0 - CSA Standard for Safety for Luminaires

Energy Star Certified



Department of Energy (DOE) and the Environmental Protection Agency (EPA) certified energy-efficient products. Rebates and incentives may available.

Visit paclights.com to verify Energy Star certified models and local rebate availability.

T24/JA8 Complaint



Can be used to comply with 2019 California Title 24 Part 6 high-efficacy LED light source requirements.

Visit paclights.com to verify models that can be used to comply with 2019 Title 24 Part 6, JA8.

CCT and Lumen Selectable

Choose lumen output and color temperature before installation with integrated switch

ETL Listed

Suitable for wet locations

Energy Star

Selected models are Energy Star® Certified.

California Title 24

Selected models can be used to conform with the requirements of California Title 24 Part 6

Lifespan

50,000-hour LED lifespan based on IES LM-80 results and TM-21 calculations

LEDs

Long-life, high-efficacy surface-mount LEDs

Color Rendering Index

CRI 90+ and CRI 82+ models available for various needs of color accuracy and lumen efficacy.

R9/R13 Value

High color performance for CRI 90+ models, R9 greater than or equal to 83, R13 greater than 93

Flicker

Silent and flicker free operations of less than 30%

IC Rated, Air Tight

Suitable for direct contact with insulation, Housing certified Air Tight as per ASTM E283

Trim

Smooth Trim

Housing

Constructed from durable aluminum sheet metal with high thermal conductivity

Maximum Ambient Temperature

Suitable for use in 40°C (104°F)

Finish

Matte White or Matte Black

Input Voltage and Operating Frequency

120V through 277V, 50/60Hz

Dimming Driver

Driver includes dimming control wiring for 0-10V dimming systems. Requires separate 0-10V DC dimming circuit.

Dims as low as 10%. Input current: FDLA04D12 - 0.12A, FDLA06D16 - 0.15A, FDLA08D22 - 0.21A, FDLA10D33 - 0.31A

Specifications



Performance

4"	6W			8W			12W		
	3000K	3500K	4000K	3000K	3500K	4000K	3000K	3500K	4000K
Lumens	534	552	576	712	736	768	1073	1108	1142
Efficacy (lm/w)	89	92	96	89	92	96	89	92	96
6"	8W			12W			16W		
	3000K	3500K	4000K	3000K	3500K	4000K	3000K	3500K	4000K
Lumens	717	740	768	1075	1109	1152	1434	1479	1525
Efficacy (lm/w)	90	92	96	90	92	96	90	92	96
8"	12W			16W			22W		
	3000K	3500K	4000K	3000K	3500K	4000K	3000K	3500K	4000K
Lumens	1091	1126	1164	1455	1501	1552	2000	2064	2128
Efficacy (lm/w)	91	94	97	91	94	97	91	94	97
10"	22W			28W			33W		
	3000K	3500K	4000K	3000K	3500K	4000K	3000K	3500K	4000K
Lumens	1970	2032	2112	2507	2587	2688	2954	3049	3143
Efficacy (lm/w)	90	92	96	90	92	96	90	92	96

Energy Efficiency - Measured Outside the Fixture. Lumen and Efficacy based on 82 CRI models.
90 CRI models' lumen outputs are approximately 85% of the 82 CRI models, with the efficacy of approximately 82-83 lm/w.

Dimensions

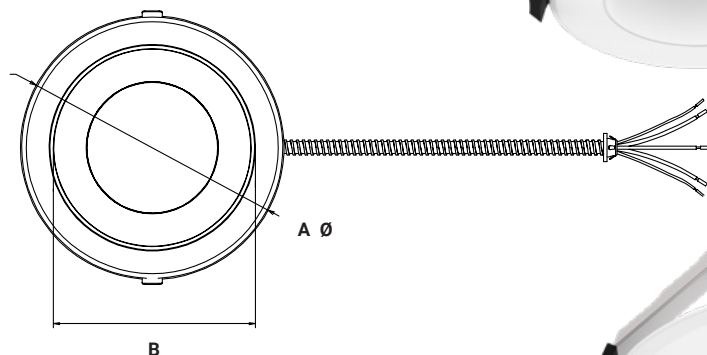
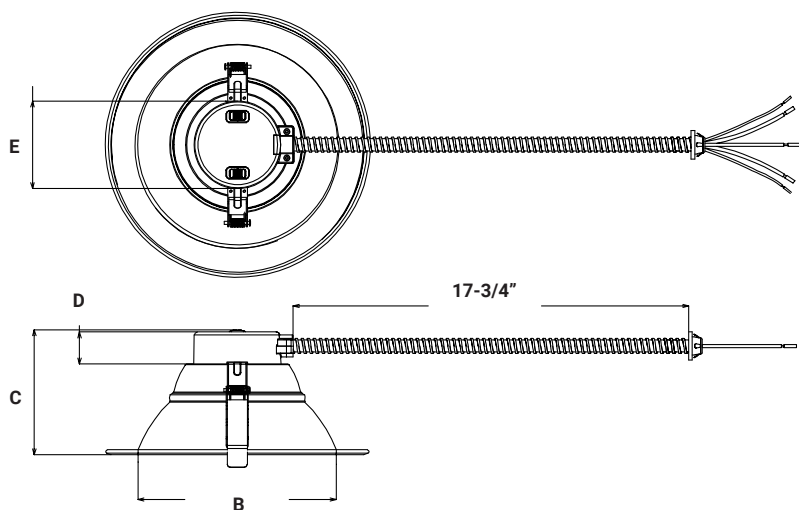

Models	A	B	C	D	E	Weight
FDLA 04 D 12	5-15/16"	3-13/16"	3-5/8"	1-1/4"	2-3/4"	0.66 lbs
FDLA 06 D 16	8-5/16"	5-15/16"	4-3/8"	1-1/4"	3-7/16"	1.13 lbs
FDLA 08 D 22	10-5/16"	7-7/8"	4-7/8"	1-1/4"	3-7/16"	1.35 lbs
FDLA 10 D 33	11-9/16"	8-5/8"	5-1/2"	1-1/4"	4-1/4"	1.65 lbs

Ordering Matrix

Family	Model	Color Accuracy	Housing Color
FDLA			
04 D 12	4", Field-adjustable 6/8/12w, 3000/3500/4000K	8 82+ CRI	W White
06 D 16	6", Field-adjustable 8/12/16w, 3000/3500/4000K	9 90+ CRI	B Black
08 D 22	8", Field-adjustable 12/16/22w, 3000/3500/4000K		
10 D 33	10", Field-adjustable 22/28/33w, 3000/3500/4000K		



PacLights, LLC

PacLights.com

800.988.6386

CustomerService@PacLights.com
Sales@PacLights.com

Printed in U.S.A.

© PacLights. The marks appearing in this catalog are registered trademarks of PacLights. Other marks used herein are recognized trademarks of their respective companies. Products shown in this brochure may be covered by U.S. and international patents. Specifications subject to change without notice.

PL_SPEC_FDLA-v1