

**Includes:** All Retrofit Kits in the RKLN Series

**CAUTION:** PLEASE FOLLOW THIS INSTRUCTION MANUAL CAREFULLY TO PREVENT ANY INJURIES OR COMPLICATIONS THAT MAY ARISE.  
**WARNING:** Before installing or maintaining the luminary, make sure all powers are **TURNED OFF**.  
 Verify that supply voltage is correct by comparing it with the label information on all fixtures.  
 Make all connections in accordance with the NEC requirements, and make sure all luminaries are properly secured to prevent any wire complications. This luminary is to always be installed with the lens facing down and its not to exceed the maximum ambient temperature rating noted on the specification sheet.

## STANDARD INSTALLATION STEPS

1. Make sure all powers are off before beginning any installations.
2. Open the Troffer Cover
3. Remove the original fluorescent tubes inside the fixture.

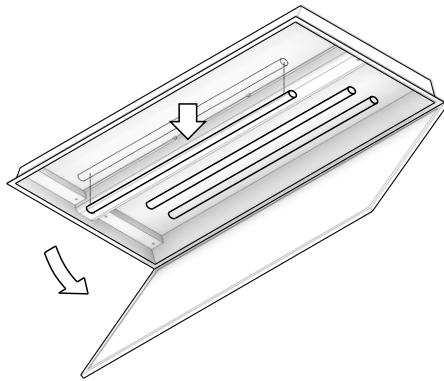

- 4) Remove the ballast cover panel.

- 5) After you remove the ballast cover, you should see the ballast. You can bypass the ballast and proceed with the installation.

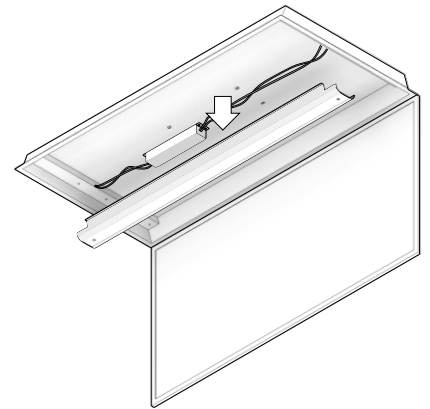

- 6) Install the RKLN LED Driver in the same location in which the ballast is placed (underneath the ballast cover) and LED strips in the same location in which the florescent lights were located by using the magnetic strips.

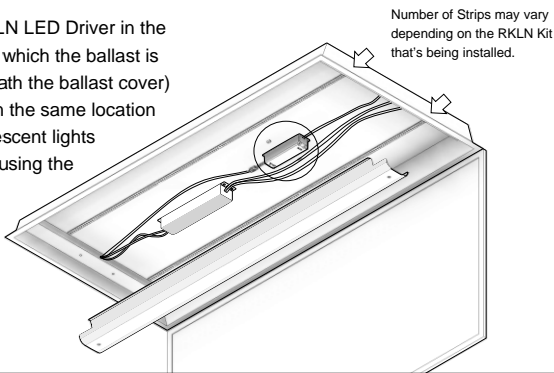

- 7a. Connect the input line of the driver and power line. Please refer to diagram at the bottom of the page.
- 7b. Connect the output line cables of the driver and the strip wires and connect the wires together with their preset connectors for an easy installation. Push together until you hear a small clicking sound.

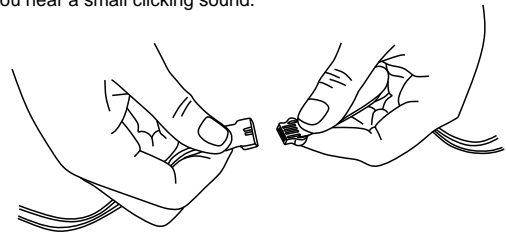

- 8) Close the Light with its frosted lens frame.
- 9) You are now ready to enjoy your Linear Retrofit Kit.

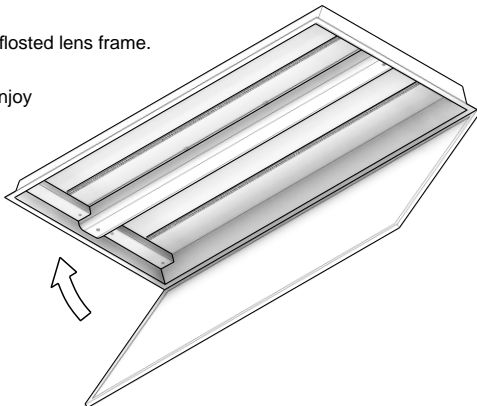

## WIRING DIAGRAM

