

IMPORTANT

SAFETY PRECAUTIONS

- Avoid testing this LED light with any electric generator.
- Ensure installation adheres to local, regional, and national laws and regulations.
- Always disconnect power before installation or maintenance.
- Proper grounding is essential for safety.

DIMMING FUNCTION

- This LED light is equipped with a dimming function.
- The light features three available dimming methods: 0-10VDC or 1-10VDC constant current dimming. PWM signal dimming. Resistance-based dimming. (Choose the appropriate dimming method based on your requirements. You may also opt not to utilize the dimming function.)
- Make your selection based on wire connection preferences, desired dimming methods, and the specific LED fixture purchased.

INSTALLATION NOTE

- Installation should only be performed by individuals with electrical expertise to prevent potential electrical shock or fire hazards.
- Wear gloves during the installation to prevent injuries.
- In case of any visible smoke or sparking from the wire, immediately disconnect the power and alert the appropriate personnel.

WIRING

Verify input AC voltage before connect. Separate and cap the 0/1-10V dimming wires if opt not to utilize the dimming function.

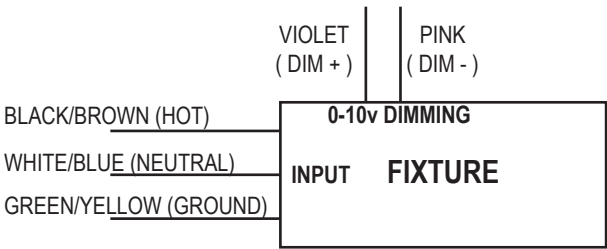

THE KIT

The Troffer Retrofit Kit (Figure 3) provides the ideal way to replace existing 2x2, 2x4, 1x4 recessed troffers, by utilizing the existing fixture housing. The kit provides all the components needed to perform the change out quickly and efficiently, allowing for system upgrades without disturbing the ceiling. The LED troffer retrofit is completely assembled within the frame. With its special design, the kit fits for both air return troffers and standard troffers.

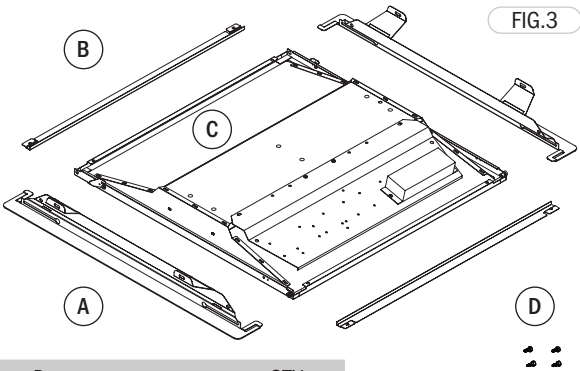

SELECT WATTAGE and/or COLOR

Selected models are wattage and color (CCT) selectable. The dip switches are located to the back of the retrofit kit assembly. Adjust the settings for wattage (Figure 1) and light color (CCT) (Figure 2) as needed.

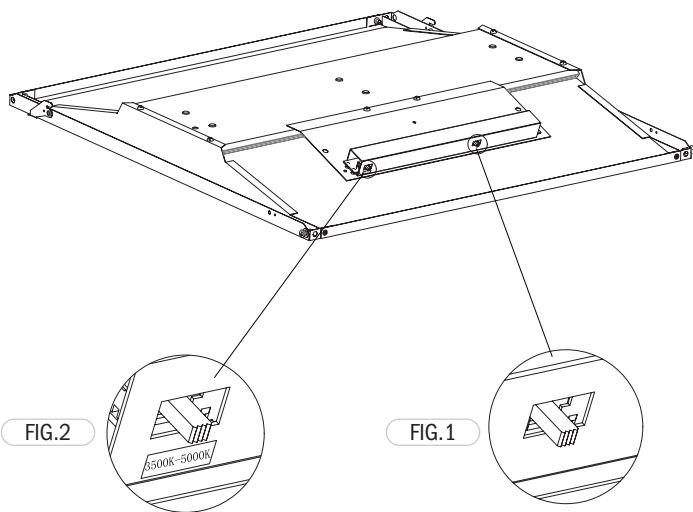

Parts		QTY
A	End Plates	2
B	Side Plates	2
C	Door Assembly body	1
D	Self-tapping Screws	4

Fixture Fromfactor	Overall Inner Dimensions
2' x 2'	610mm x 608mm x 78mm H
2' x 4'	1220mm x 608mm x 78mm H
1' x 4'	1220mm x 302mm x 78mm H

NOTE: the housing of the existing fluorescent luminaries should have an overall inner dimensions larger than in this table.

SENSOR/CONTROL INSTALLATION

The RKTF is equipped with a sensor/control receptacle. To install the sensor or control device, first remove the protective cap located at the front of the fixture. This can be done using a Philips screwdriver. Once the cap is removed, gently connects the control cable to the sensor/control, and insert the sensor/control into the opening.

RETROFIT

- 1 Step 1: Preparation**
Ensure all power is disconnected before installation. Remove existing fixture components (lens/lens frame, parabolic louver, reflectors/ballast covers, brackets, lamps/lamp holders). Retain supply and grounding leads. Note: Dispose of lamps and components in compliance with federal and local regulations. (Figure 4)

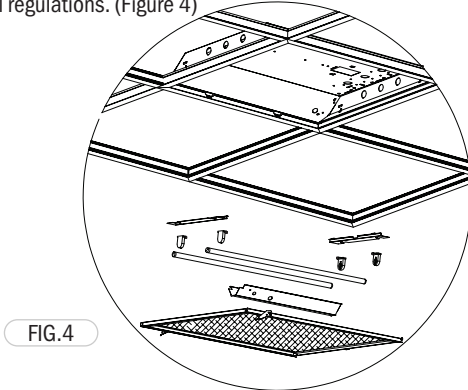

- 2 Step 2: Installing End Brackets**
Attach LED panel end brackets at each end of the fixture. Lift the fixture slightly and place the brackets between the fixture and T-grid. (Figure 5)

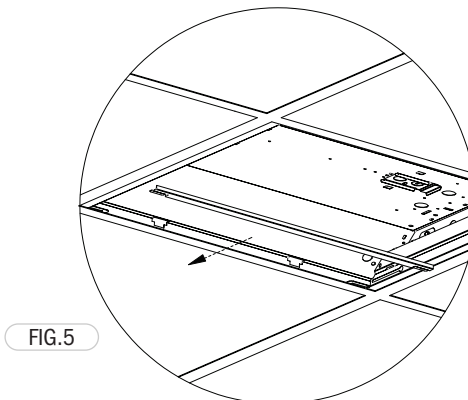

- 3 Step 3: Adjusting for Gaps**
If a gap is present between the fixture and T-grid, install LED panel side brackets for a snug fit. Insert the two tabs of the side brackets into the slots of the end brackets. Secure the brackets using the provided #8x1/2" self-drilling screws. (Figure 6)

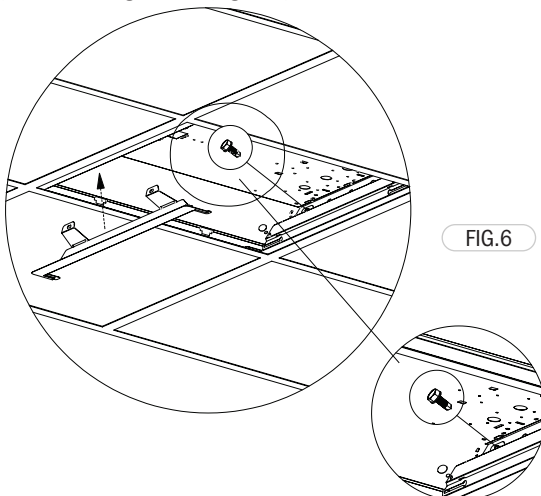

- 4 Step 4: Door Assembly Placement**
Align the door assembly body with the keyholes of the end brackets. Slide it horizontally to the end of the slots. (Figure 7)

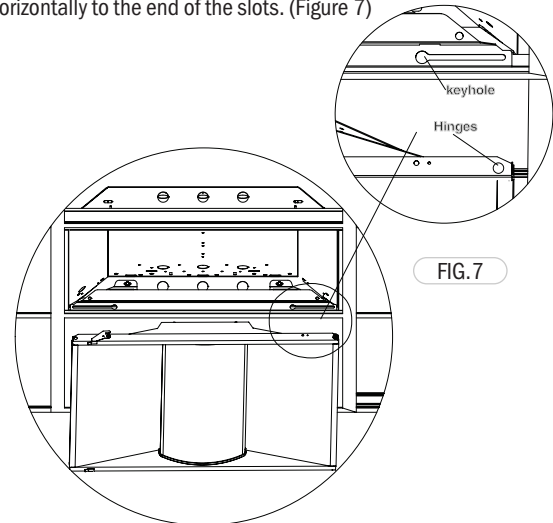

- 5 Step 5: Safety and Wiring**
Attach safety cables to the holes in the end brackets. Connect wire leads of the troffer kits to the main power leads using wire caps (Black to Live, White to Neutral, Green to Grounding). (Figure 8)

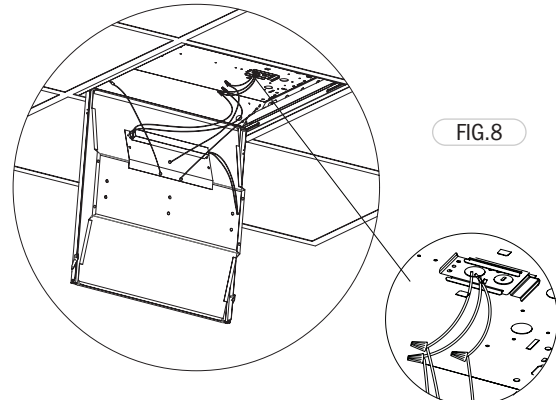

- 6 Step 6: Securing the Assembly**
Lock the door assembly body in place using the latches riveted on each end of the door frame. (Figure 9)

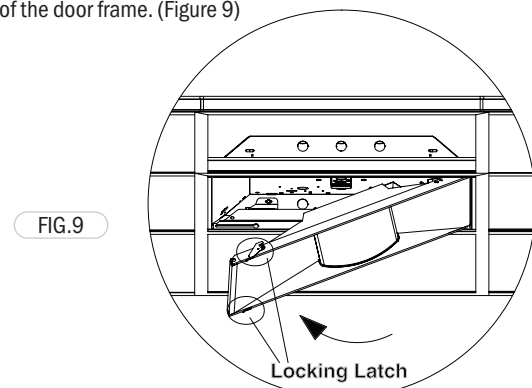

- 7 Final Check**
Ensure all components are securely installed and check connections before restoring power.