

## IMPORTANT

### SAFETY PRECAUTIONS

- Avoid testing this LED light with any electric generator.
- Ensure installation adheres to local, regional, and national laws and regulations.
- Always disconnect power before installation or maintenance.
- Proper grounding is essential for safety.

### DIMMING FUNCTION

- This LED light is equipped with a dimming function.
- The light features three available dimming methods: 0-10VDC or 1-10VDC constant current dimming. PWM signal dimming. Resistance-based dimming. (Choose the appropriate dimming method based on your requirements. You may also opt not to utilize the dimming function.)
- Make your selection based on wire connection preferences, desired dimming methods, and the specific LED fixture purchased.

### INSTALLATION NOTE

- Installation should only be performed by individuals with electrical expertise to prevent potential electrical shock or fire hazards.
- Wear gloves during the installation to prevent injuries.
- In case of any visible smoke or sparking from the wire, immediately disconnect the power and alert the appropriate personnel.

## WIRING

Verify input AC voltage before connect. Separate and cap the 0/1-10V dimming wires if opt not to utilize the dimming function.

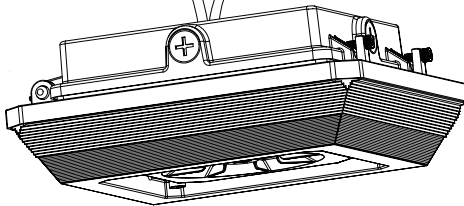
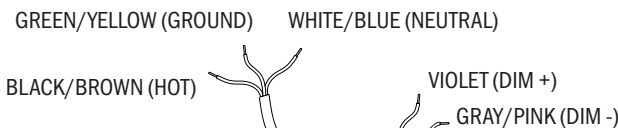
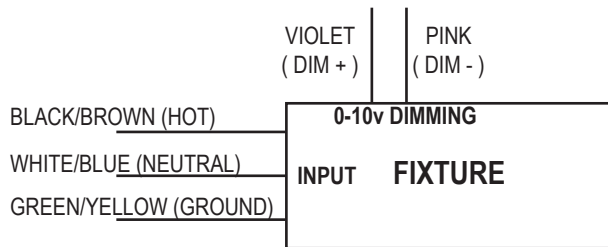

## SELECT WATTAGE and/or COLOR

Selected models are wattage and color (CCT) selectable. The dip switches are located in the fixture, and can be accessed by removing the metal door (rear of the fixture) of the LED driver compartment. Adjust the settings for wattage (Figure 1) and light color (CCT) (Figure 2) as needed.

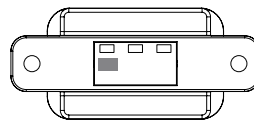

FIG.1

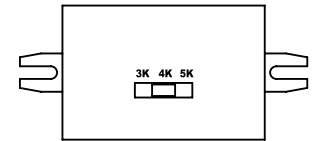

FIG.2

## SENSOR/CONTROL INSTALLATION

The FCPG is equipped with a sensor/control receptacle. To install the sensor or control device, first remove the protective cap located at the bottom of the fixture. This can be done using a Philips screwdriver. Once the cap is removed, gently screw the sensor/control into the opening, as illustrated in Figure 3.

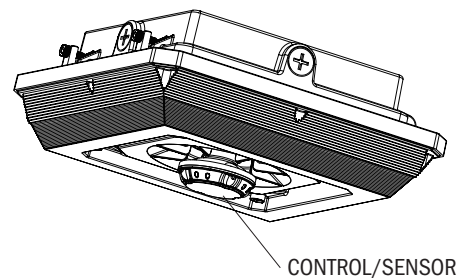

FIG.3

## MOUNTING OPTIONS

### Pendant/Conduit Mount

The fixture can be attached to a 3/4" NPT conduit.(Figure 4).

1. Removing the Compartment Door  
Unscrew and remove the door of the LED driver compartment from the fixture by loosening the two locking screws.
2. Accessing the NPT Opening:  
Use a Philips screwdriver to remove the knockout (KO) cover from the 3/4" NPT opening on the door.
3. Conduit Connection:  
Attach a 3/4" NPT conduit through the opening in the door. Ensure to apply silicone gel around the opening to guarantee a watertight seal.
4. Replacing the Fixture:  
Carefully insert and align the fixture back into its position on the door.
5. Wiring and Settings Adjustment:  
Follow the provided wiring diagram to connect the wires. Make necessary adjustments to the wattage and CCT (Correlated Color Temperature) to set the desired light color.
6. Securing the Fixture:  
Rotate the fixture to its closed position.
7. Final Locking:  
Replace and tighten the locking screws to secure the fixture in place.

FIG.4

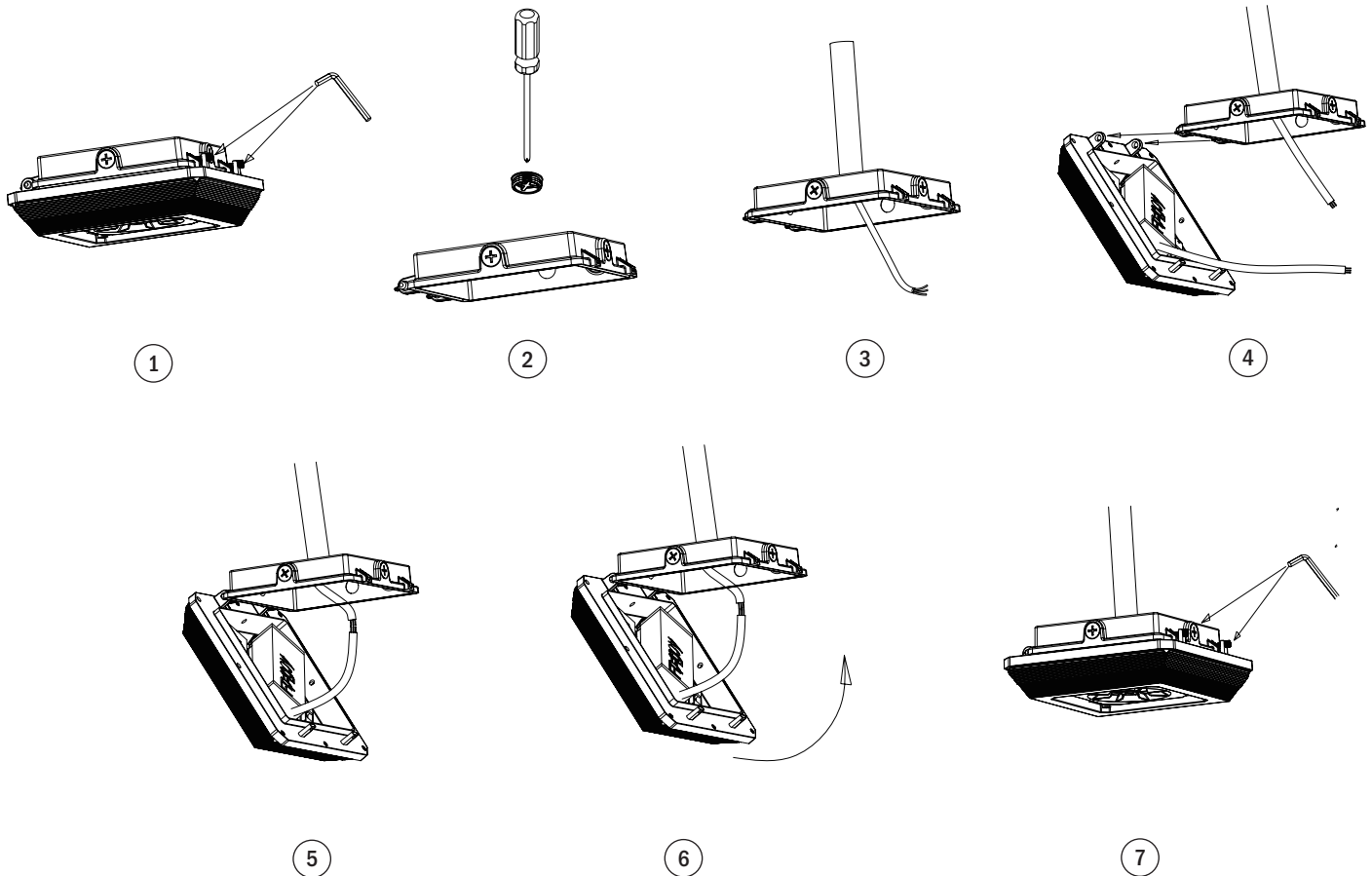

## Surface Mount

The fixture can be mounted to a flat surface of ceiling.(Figure 5).

1. Removing the Compartment Door  
Unscrew and remove the door of the LED driver compartment from the fixture by loosening the two locking screws.
2. Accessing the NPT Opening:  
Use a Phillips screwdriver to remove the knockout (KO) cover from the 3/4" NPT opening on the door.
3. Prepare mounting:  
Drill mounting holes on the ceiling, if there's no junction box
4. Mounting the Door to the Ceiling:  
Use appropriate mounting hardware (not supplied) to securely mount the door to the ceiling. Ensure the hardware is suitable for the ceiling material and weight of the fixture.
5. Replacing the Fixture:  
Carefully insert and align the fixture back into its position on the door.
6. Wiring and Settings Adjustment:  
Follow the provided wiring diagram to connect the wires. Make necessary adjustments to the wattage and CCT (Correlated Color Temperature) to set the desired light color.
7. Securing the Fixture:  
Rotate the fixture to its closed position.
8. Final Locking:  
Replace and tighten the locking screws to secure the fixture in place.

FIG.5

