

Includes: FWPT035, FWPT055, FWPT080, FWPT100, and FWPT120

CAUTION: PLEASE FOLLOW THIS INSTRUCTION MANUAL CAREFULLY TO PREVENT ANY INJURIES OR COMPLICATIONS THAT MAY ARISE.
WARNING: Before installing or maintaining the luminaire, make sure all powers are **TURNED OFF**.
 Verify that supply voltage is correct by comparing it with the label information on all fixtures.
 Make all connections in accordance with the NEC requirements, and make sure all luminaires are properly secured to prevent any wire complications. This luminaire is to always be installed with the lens facing down and its not to exceed the maximum ambient temperature rating noted on the specification sheet.

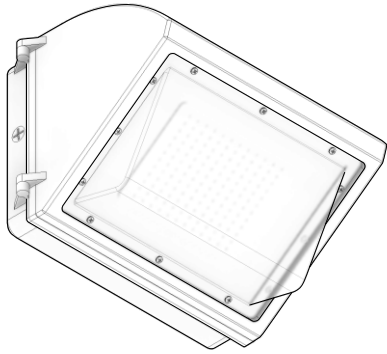

(A) STEPS FOR JUNCTION BOX INSTALLATION

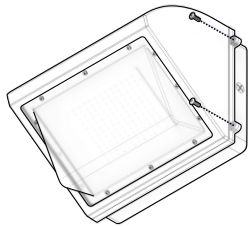

1. Remove the (2) screws on the right side of the fixture to remove the back box from the pins on the front housing. Disconnect the wiring from the front of the fixture and the LED Driver.

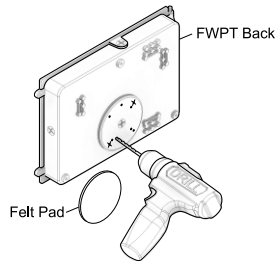

2. The back box for the FWPT has indented holes which can be used to be drilled into. Align the desired J-Box (not included) for the project and drill holes to align with the J-box of your choosing.

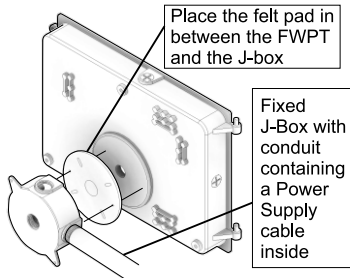

3. Fasten the J-Box to the Back of the FWPT Back panel and remove the Conduit plug on the center using a slotted screw driver.

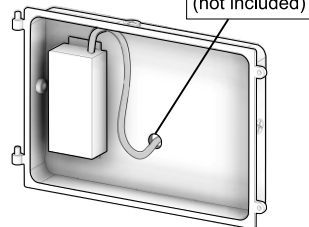

4. Run the FWPT input cable through the conduit hole at the back side of the fixture in order to run the input cables to the junction box. Then apply water-proof sealant on the opening.

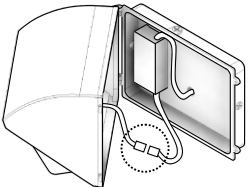

5. Reattach the Front Housing for the FWPT and connect the LED Panel Cable to the LED Driver Output Cord.

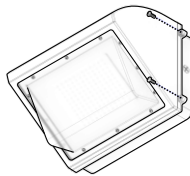

6. Close the housing and fasten the (2) M6 screws.

7. Remove the two drain hole caps on the bottom side of the FWPT luminaire.

8. The FWPT Wallpack fixture is ready to be powered and turn on.

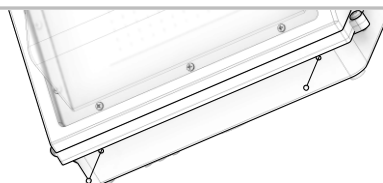

(B) STEPS FOR SURFACE MOUNT INSTALLATION

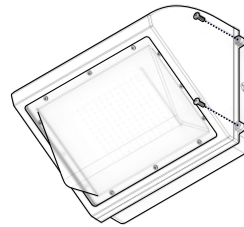

1. Remove the (2) screws on the right side of the fixture to remove the back box from the pins on the front housing. Disconnect the wiring from the front of the fixture and the LED Driver.

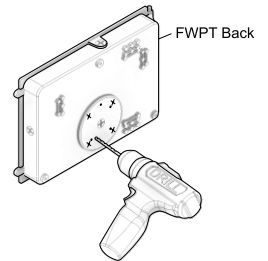

2. The back box for the FWPT has indented holes which can be used to be drilled into. Drill out holes on the indents to clear mounting screws. The diameter of the holes depends on the mounting screws being used.

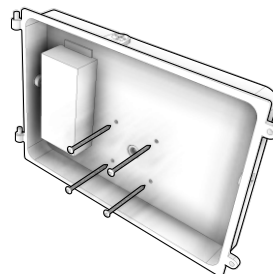

3. Fasten the FWPT Back panel to the mounting surface using mounting screws. (not included). Make sure to align the conduit opening to the hole in the wall.

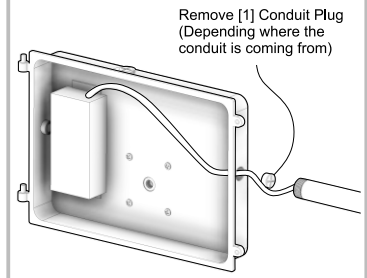

4. Run the FWPT input cable through the conduit hole in order to connect to the conduit with the Power Supply Cable Inside. Follow the Wiring Diagram.

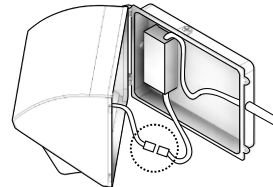

5. Reattach the Front Housing for the FWPT and connect the LED Panel Cable to the LED Driver Output Cord.

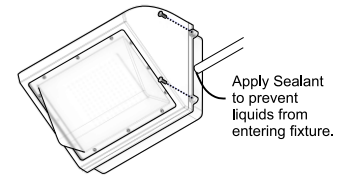

6. Close the housing and fasten the (2) M6 screws.

WIRING DIAGRAM

The cable consists of 3 conductor: ACL (black), ACN (white), and a ground (green). These conductors are to be connected to a 100-277V AC Power Supply Cable.

