

SE-MT-MC054VRCD- Microwave Motion Sensor

Includes: FLHA2D090, FLHA2D110, FLHA2D162, FLHA4D178, FLHA4D223, FLHA4D321



CAUTION: PLEASE FOLLOW THIS INSTRUCTION MANUAL CAREFULLY TO PREVENT ANY INJURIES OR COMPLICATIONS THAT MAY ARISE.

WARNING: Before installing or maintaining the luminaire, make sure all power is **TURNED OFF**.

Verify that supply voltage is correct by comparing it with the label information on all fixtures.

Make all connections in accordance with the NEC requirements, and make sure all luminaires are properly secured to prevent any wire complications. This luminaire is to always be installed with the lens facing down and its not to exceed the maximum ambient temperature rating noted on the specification sheet.

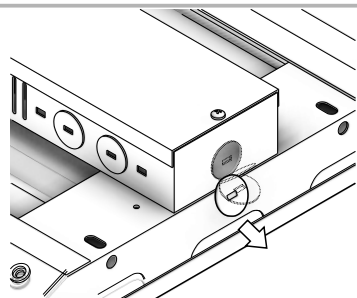

Step 1- Determine which end side of the FLHA would be the best location to install the Motion Sensor, once determined, remove the small round tab from the back box in order to expose the knock out. This will be where the SE-MT-MC054VRCD will be inserted and installed.

PART NO.	IMAGE	DESCRIPTION	QTY
SE-MT-MC054VRCD		Microwave Motion Sensor	1
SE-MT-MH01 (Optional)		Remote Control for SE-MT-MC054VRCD Microwave Motion Sensor capable of control detection area, hold time, daylight threshold, dimming and few other features.	1

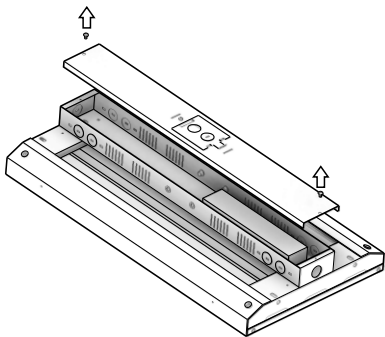

Step 2- Using a #2 Phillip screwdriver, remove the two screws to uncover the top cap from the back box. Once the cap is removed, the qualified electrician will have access to the LED Driver and will now be able to screw the Motion Sensor in place.

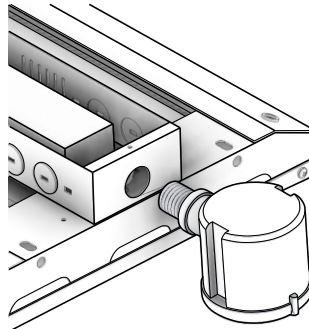

Step 3- Insert the Microwave Sensor on the Knock out and screw it together with the back box using the nut provided with the sensor. Once the sensor is installed. Please make sure the detector is facing DOWN.

Step 4- Once the motion sensor is properly installed to the orientation and tilt as desired, use the following wiring diagram in order to make all the proper wire connections.

Step 5- Follow this wiring diagram in order to properly connect the Motion Sensor to the LED Driver.

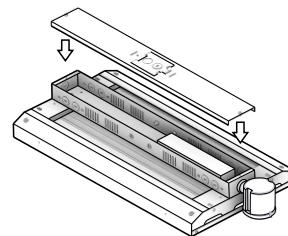
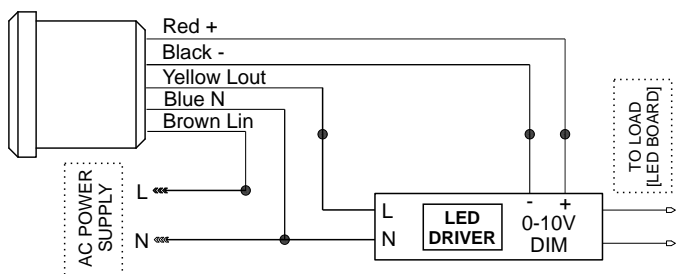

Step 6- Using a #2 Phillips Screwdriver, fasten the cap back to the Back Box of the High Bay.

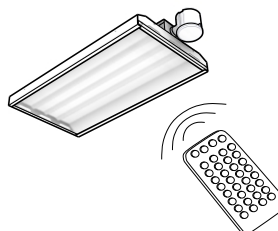

Step 7- (Optional) SE-MT-MH01 Remote Control can be used to adjust the settings on the Microwave Motion Sensor. For additional information on how to use the remote, please refer to the Installation Sheet for the SE-MT-MH01.