

CAUTION: PLEASE FOLLOW THIS INSTRUCTION MANUAL CAREFULLY TO PREVENT ANY INJURIES OR COMPLICATIONS THAT MAY ARISE.
WARNING: Before installing or maintaining the luminaire, make sure all powers are **TURNED OFF**. Verify that supply voltage is correct by comparing it with the label information on all fixtures. Make all connections in accordance with the NEC requirements, and make sure all luminaires are properly secured to prevent any wire complications.

INSTALLATION STEPS

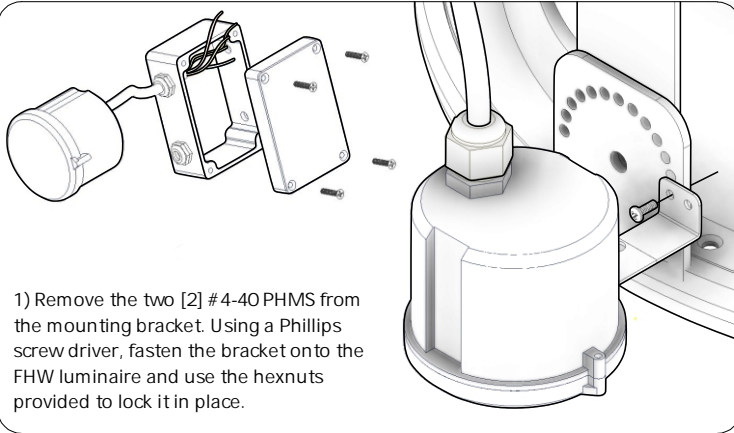

1) Remove the two [2] #4-40 PHMS from the mounting bracket. Using a Phillips screw driver, fasten the bracket onto the FHW luminaire and use the hexnuts provided to lock it in place.

2) Refer to the wiring diagram provided to connect the ACHUMO to the Dimmable LED Driver. Try to aim the sensor toward the desired detectable area.
 3) Make sure all wiring connections are made inside the J-Box provided and are properly sealed by an authorized electrician.
 4) Remove the screw and cap of the sensor and adjust the DIP switches to get the desired settings. Sensor data can be precisely set for each specific application. Once the program is set, close and fasten the cap.

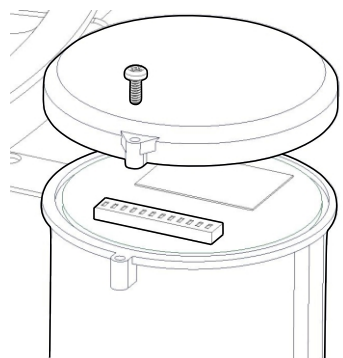

ACHUMO: MICROWAVE OCCUPANCY DETECTION

PART NO.	IMAGE	DESCRIPTION	QTY
ACHUMO		Microwave occupancy sensor with J-Box	1
ACHUMO-MB4		Mounting Bracket for the ACHUMO occupancy sensor	1
10-00032		#4-40 Pan Head Machine Screw	2
10-00033		#4-40 Hex Nut	2

WIRING DIAGRAM

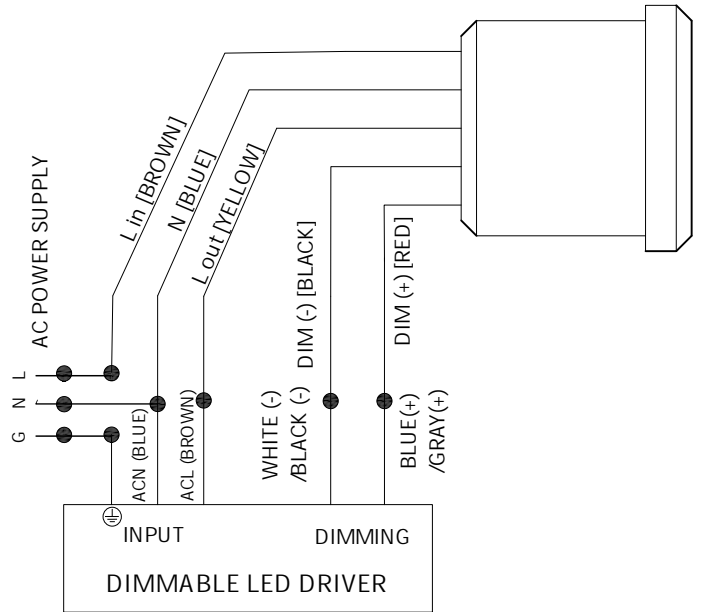

ON		1	
	I	ON	100%
	II	-	50%

(1) DETECTION AREA

Detection area can be reduced by selecting the combination on the DIP switches to fit precisely each application

ON		2	3	4	
	I	ON	ON	ON	5s
	II	-	ON	ON	30s
	III	ON	-	ON	90s
	IV	-	-	ON	3min
	V	ON	ON	-	20min
	VI	-	-	-	30min

(2-4) HOLD TIME

Refer to the time period the lamp remains at 100% illumination after no motion detected

ON		8	9	
	I	ON	ON	50%
	II	-	ON	30%
	III	ON	-	20%
	IV	-	-	10%

(8-9) STAND-BY DIMMING LEVEL

The low light level you would like to have after the hold time in the long absence of people

ON		5	6	7	
	I	ON	ON	ON	60m+
	II	-	ON	ON	60min
	III	ON	-	ON	30min
	IV	-	-	ON	10min
	V	ON	ON	-	5min
	VI	-	-	-	5s

(5-7) STAND-BY PERIOD

Refer to the time period the lamp remains at 100% illumination after no motion detected

(10-12) DAYLIGHT SENSOR

The sensor can be set to only allow the lamp to illuminate below a defined ambient brightness threshold.

When set to Disable mode, the daylight sensor will switch on the lamp when motion is detected regardless of ambient light level. Note that daylight sensor is active only when lamp totally switches o

ON		10	11	12	
	I	ON	ON	ON	Disable
	II	-	ON	-	20 lux
	III	ON	-	-	10 lux
	IV	-	-	-	5 lux