

## AC-ALB-FM2 Flood Mount

Includes: FALB185, FALB240, FALB300



**CAUTION:** PLEASE FOLLOW THIS INSTRUCTION MANUAL CAREFULLY TO PREVENT ANY INJURIES OR COMPLICATIONS THAT MAY ARISE.

**WARNING:** Before installing or maintaining the luminary, make sure all powers are **TURNED OFF**.

Verify that supply voltage is correct by comparing it with the label information on all fixtures.

Make all connections in accordance with the NEC requirements, and make sure all luminaries are properly secured to prevent any wire complications. This luminary is to always be installed with the lens facing down and its not to exceed the maximum ambient temperature rating noted on the specification sheet.

### DRILLING TEMPLATE

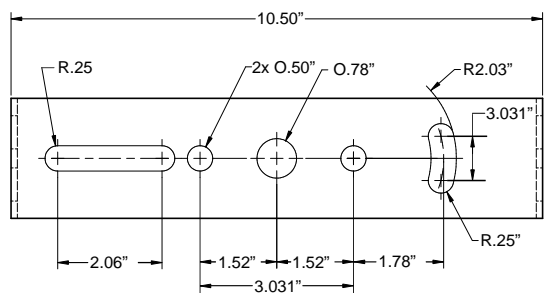

1. Fasten the two AC-ALB-FM2 angle brackets to the back side of the FALB fixture with the provided socket head machine screws. Install the angles brackets with the back plate towards the inward direction to the fixture.

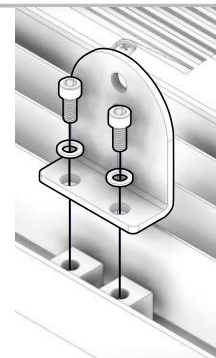
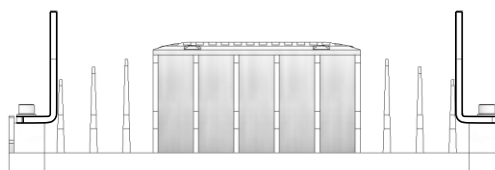

2. Once the angle brackets are fastened onto the FALB fixture. Using the provided washers and machine screws, fasten the AC-ALB-FM2 brackets to the angle brackets. Do not tighten completely to allow of adjusting.

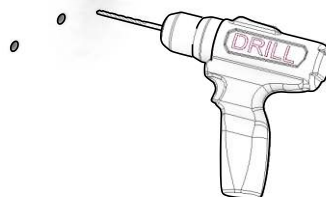
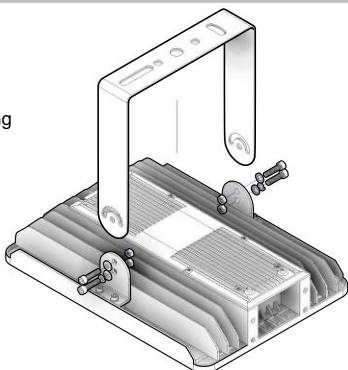

3. Drill holes on the mounting surface by following the Drilling Template to mount the AC-ALB-FM2 flood mount to the desired height.

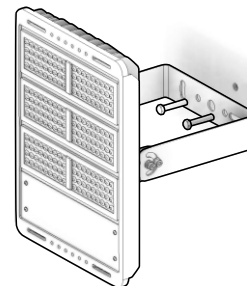

4. Fasten the AC-ALB-FM2 Flood Mount bracket to the mounting surface using the appropriate mounting bolts. (not included)

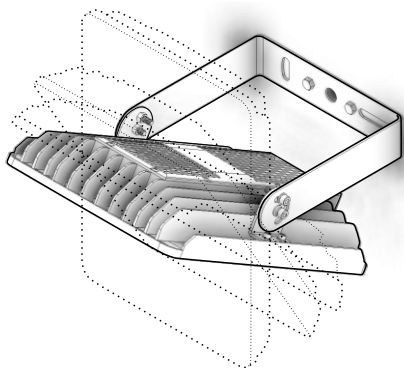

5. Adjust the tilt angle on the FALB to get the light beam pointing towards the desired location.

6. Tighten the socket-head machine screws with an allen wrench to keep the fixture in place.

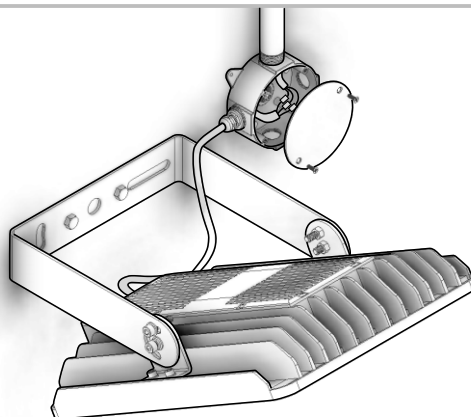

7. The FALB power cable must be fed into a Junction Box specific for outdoor applications. Follow the wiring diagram provided to install the FALB to the power cable. All wiring must be done inside the J-box and all cables must be fed through a water-proof connector. All wiring must be installed by a certified electrician and must be compliant to NEC standards.

### WIRING DIAGRAM

The LED Driver input cable consists of 3 conductors: ACL (black), ACN (white), and ground (green). These conductors are to be connected to a Power Supply Cable.

(For Dimmable Fixtures) The Dimming cable consists of 2 conductors:  
DIM+ (Blue/ Brown+Gray)  
DIM- (White/ Blue+ Black)

