

AC2WPPS1V/2V- PHOTOCELL

Includes: F2WP 024, F2WP 048, F2WP 100, F2WP 120, and F2WP150

INSTALLATION:

1) Using a #2 Phillips Screw Driver, remove the (2) M6 screws on the Right hand side of the luminaire to remove the Back Box from the pins. Hang on to the M6 screws to fasten them back to the housing once all wiring is complete.

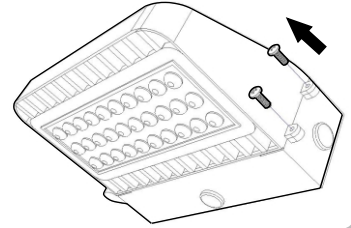

PART NO.	IMAGE	DESCRIPTION	QTY
AC2WPPS		Plastic Casing for the AC2WPPS1V/2V	1
AC2WPPS1V/2V		Photocell, 5 sec delay on/o . Sensitivity:10-20 Lux (On) 40-80 Lux (O) 1V Version: 120vAC 2V Version: 277vAC	1
10-00002		M4-0.7 X 10 mm Pan Head Machine Screw	2

2) Unscrew the top NPT1/2 conduit cap from the Back Box.

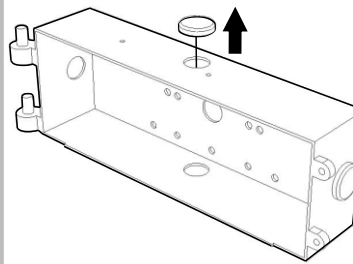

3) Get the AC2WPPS and fasten the AC2WPPS1v Photocell to the case. This is done by first unscrewing the nut already being provided with the photocell.

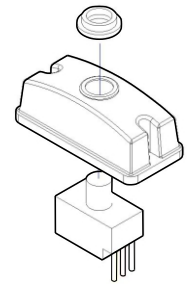

4) Run the cables from the photocell into the top hole that was uncovered from the conduit cap in Step 2. Get the (2) M6-0.7 x 10mm pan head machine screws and fasten the AC2WPPS to the top of the F2WP. The F2WP already has two thread holes on the top to allow the AC2WPPS case to be properly placed and installed. A #2 Screw Phillips Driver will be needed. Once the Plastic case is installed on top of the WallPack, APPLY WATERPROOF SEALANT along the perimeter of the case in order to prevent any liquids from entering the case and affecting the photocell.

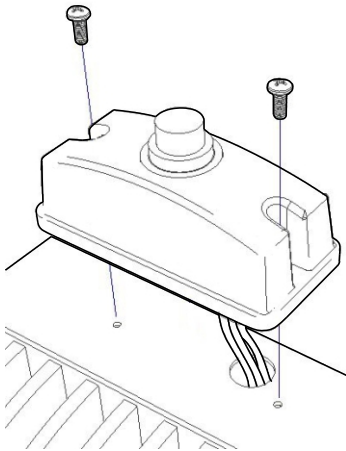

5) Follow the Wiring Diagram.

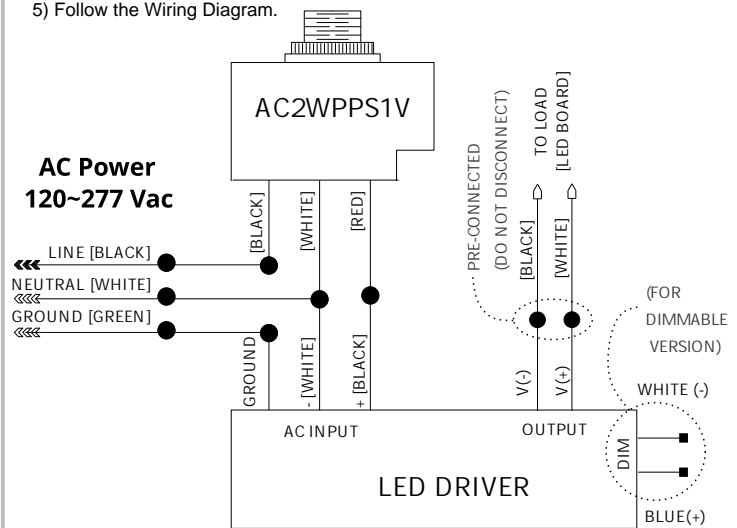

6) Use Wire Nuts, Wire Connectors, or Butt Splices at P.O.C. All Connections must be sealed for moisture. Let the Black wire from the photocell run out from the back side of the Back Box since it will be getting connected to the hot wire from the AC Power supply. Use a 3-way connector for the white wires and bring them out from the back side. Run the ground wire out if its on the LED Driver. (Wire Connectors not included)

7) Screw the Back Box into the wall. The quantity and screw specifications will vary due to the mounting surface. Once all the wires are property connected, close the housing and fasten the (2) M6 screws that were removed in Step 1 are tighten them properly.

